

THREE FUNCTIONS
IN A MINIMUM OF
SPACE

Motion Detector for 55mm frames – indoor

HmIP-SMI55

The compact motion detector with high-performance PIR sensor includes three functions in one device: The precise detection of the movements for automatic switching of lights offers secure monitoring of rooms. At the same time, the push-button offers manual control of Homematic IP devices and functions.



homematic ^{IP}
Smart Living, Simply Exciting.

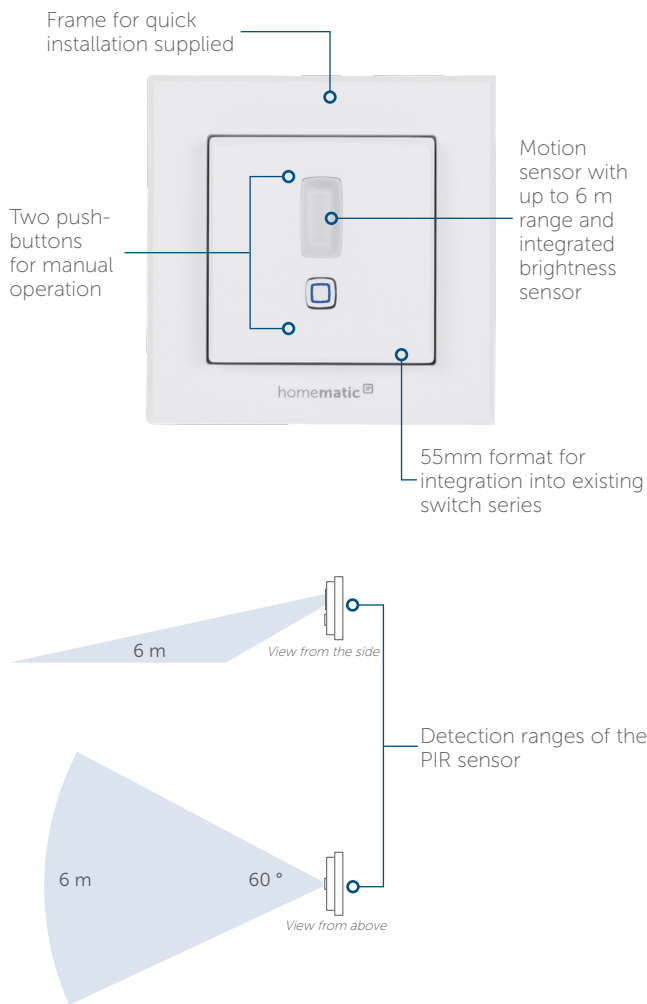

To enable operation, the device has to be connected with one of the following solutions:

- Homematic IP Access Point with free smartphone app and free cloud service
- Central Control Unit CCU2/CCU3 with the local user interface WebUI
- Third-party solutions of partners

TECHNICAL SPECIFICATIONS

Supply voltage	2x 1.5 V LR03/micro/AAA
Battery life	2 years (typ.)
Degree of protection	IP20
Dimensions (W x H x D):	
Without frame	55 x 55 x 20 mm
Including frame	86 x 86 x 21.5 mm
Ambient temperature	5 to +35 °C
Weight	90 g (including batteries)
Radio frequency band	868.0-868.6 MHz 869.4-869.65 MHz
Typ. open area RF range	150 m
Detection range	6 m
Detection angle horizontal	80°
Detection angle vertical	20°

INCREASED COMFORT AND SECURITY

Automatic light control when motion is detected. Depending on the brightness in the room, the light is switched on only when it is needed, for greater convenience and energy savings. As part of a Homematic IP security solution, the motion detector can not only switch on the lights but also trigger an alarm.

ALL-IN-ONE: MOTION DETECTOR AND SWITCH

The integrated push-button offers manual control of devices or system functions – independent of motion detection.

RELIABLE POWER SUPPLY

Two micro-batteries supply the device with energy for two years (typically). When using the motion detector in a Homematic IP security solution, a Homematic IP Power Supply Unit for brand switches (HmIP-BPS) is required for power supply.

MODULAR DESIGN FOR HIGH FLEXIBILITY

Thanks to its modular design, the motion detector offers individual and flexible use:

- ✓ Adhesive or screw mounting in the supplied clip-on frame with enclosed mounting material
- ✓ Installation on a free flush-mounted box with corresponding mounting plate
- ✓ Easy to integrate into existing switches with 55 mm frames of the following manufacturers: e.g. Berker, Busch-Jaeger, GIRA, Merten, JUNG, Kopp and ELSO

Examples:



merten 1-M



GIRA Standard 55

LOGISTICAL DATA

Product reference	151769A0
EAN code	404796517695
Short description	HmIP-SMI55
Packing unit	90
Packing dimensions	122 x 112 x 48 mm
Weight incl. packaging	171.2 g

PACKAGE CONTENTS

Homematic IP Motion Detector for 55mm frames – indoor
Clip-on frame and mounting plate
Mounting material (screws, plugs and adhesive strips)
1.5 V LR03/micro/AAA batteries (2x)
User manual